

SELECT A CITY ▾

INDUSTRIES & TOPICS

CRANE WATCH TRACKS AREA'S BIGGEST CONSTRUCTION PROJECTS

LIMITED TIME OFFER  
Subscribe Now

SIGN IN  
Your Account ▾  
WELCOME  
Your Account ▾

🏠 NEWS   LISTS & AWARDS   PEOPLE & COMPANIES   EVENTS   MORE...   🔍

**FOR THE EXCLUSIVE USE OF LBEST@CASTLEDEV.COM**

From the Pittsburgh Business Times:  
<https://www.bizjournals.com/pittsburgh/news/2017/08/11/castlebrook-gets-under-way-with-distribution.html>

# Castlebrook gets under way with distribution center near Beaver County

➤ SUBSCRIBER CONTENT:   Aug 11, 2017, 7:58am EDT

Castlebrook Development has begun site work on about 100 acres its purchased in New Galilee, Beaver County, on what will start with a 416,000-square-foot distribution center.

Working under the affiliate BIKOP LLC, Castlebrook is pursuing the development on a site that could eventually total 1 million square feet of distribution space on a junction of the Pennsylvania Turnpike, Interstate 376 and Routes 60 and 351.

The update on the established plan was announced by JLL, which will be marketing the project, led by [Rick O'Brien](#), an executive vice president with the real estate company.

Castlebrook partnered in the development of the initial Turnpike Distribution Center, a 410,389-square-foot facility built in the vicinity in 2007.

**Tim Schooley**  
Reporter  
*Pittsburgh Business Times*

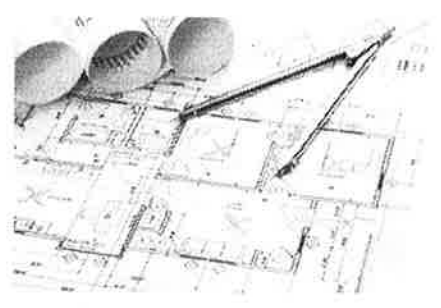

GARGANTIOPA  
Construction planning drawings on the table and two yellow pencils